

Discover Us



Welcome

KOPWA was established over 60 years ago to provide high quality in-home and residential care to elderly community members on Sydney's upper north shore. As a community-based organisation, we offer exceptional aged care services from our freshly upgraded premises in the suburb of Roseville. Our residential facility is currently home to 54 individuals and is set to welcome 48 more thanks to a recent expansion and refurbishments. We support many more clients by delivering at-home and respite care.

Our culture

At KOPWA, we understand that a positive culture is essential to help us achieve our goal of being the most highly respected provider of aged care services in Sydney. The staff we employ are highly trained and passionate about providing individualised care to improve the wellbeing of each resident. Our executive team is focused on making sure they have an empowering and engaging place to work. Because our staff are happy and supported, we have the confidence that the care they provide will always meet expectations.

"Living here at Kopwa, I have always felt like I am with family."

- Lucy, Resident



Why Kopwa

KOPWA has always existed for the sole purpose of serving the community and the residents we work with each day. Because we are not for profit, we are able to invest our earnings into improving our team, our facilities and our services. Being a boutique aged care operator means we are focused on the people who matter to us the most; our staff and the families we support with residential and home-based aged care. When you or your loved one arrives at KOPWA, you can be assured of a wonderful environment and premium care.

Round-the-clock support

Residents become family at KOPWA. Unlike many other aged care facilities, our management is based on-site, not in a distant office. This helps us to stay in touch with our team and ensure our high standards are being maintained. Registered Nurses are available to residents 24/7. There is also access to a range of Allied Health providers who visit regularly to support the physical and mental wellbeing of our residents. The beautiful, calm surroundings and hotel-style facilities we offer add to the appeal of living at KOPWA.



Lifestyle

KOPWA aims to create an inclusive environment for all. We welcome staff and residents from all backgrounds and love being a multicultural community. The culture at KOPWA is all about positivity. Residents are encouraged to develop friendships so that their new accommodation feels like home. When you visit, you will notice there is no shortage of things to do, with gardening, bingo, book club and music therapy just some of the activities on offer.

Care

Residents health and wellbeing is the core of what we do. We aim to promote self-esteem, dignity and autonomy in how we care for our residents based on care delivery philosophies through intended care planning and collaboration with our Doctors, Allied Health partners, families, friends and the wider community. Our range of care service includes those who require low, high, dementia-specific and palliative care. Another popular care service is our in-home care services for the individuals living in the wider community. Our care management and allied health staff visiting can provide external care in the client's home. Residential respite care services are available on request for when family members are unavailable to provide support during a period of time.

Amenities

KOPWA residents feel like they are staying at a hotel, with spacious rooms, ensuite bathrooms, regular visits from cleaners and a full laundry service available. In the restaurant, meals are prepared by a skilled, highly experienced chef in many cuisines, tailoring dietary needs of our residents. Outdoors, the surroundings and courtyard are immaculately presented, with walkways offering shade and protection. We have sizeable dedicated palliative care rooms located in a refurbished heritage building away from the other rooms for families to spend private time with their loved ones.

"I love the delicious food menu options we have."
- Edith, Resident



Prepared for the future

With a history stemming back to 1957, KOPWA is one of the best-established Aged Care facilities on Sydney's upper north shore. In addition to our proud heritage, we are excited about what's coming next. With our latest upgrades, architects and our partners at Total Construction have created a beautiful new facility, expanding our capacity which includes an underground car park.

When you visit, you will notice we have blended old with new, preserving our heritage and the look of the local area while looking to the future with modern fittings and features. And while our facility is state-of-the-art, our service combines the latest technology and forward-thinking with a genuine level of personalised care that will never go out of style.

"I have exercise physios who really care for me."
- Liz, Resident

State of the Art Tech

At KOPWA, we use technology to promote convenience, health, safety and wellbeing. Our Advanced Nurse Call system means help is never far away in an emergency. Fob-activated entry-point security restricts unauthorised access and delivers peace of mind for residents and their families. Rooms and beds have been carefully designed, with fall-prevention innovation that makes access easier. As a result, our residents enjoy more independence throughout the day.

High speed NBN internet and WiFi provides a connection with the outside world, allowing residents to bring their own device to play games or check messages. KOPWA also offers the latest technology in senior activities, with virtual games played on our interactive 'Tovertafel' table.

"Our digital table games are great fun, we can get noisy!"
- Megan, Resident





Features

You will always feel at home at KOPWA thanks to the community feel, the dedicated staff and the friendly management team. There is a smiling face waiting around every corner and family members are always welcome to visit. Around the premises, you will notice the luxury feel that comes with welcoming furniture, beautiful decor and plenty of light-filled spaces.

Residents are invited to dine at our in-house restaurant, which offers high quality, chef-prepared meals from a varied menu. Shared activity rooms encourage social interactions and reflect the community-first culture we have here at KOPWA. Outdoor areas are designed to be enjoyed year-round and are ideal for spending time with family and friends.

“Our new rooms are like a hotel, only nicer with a beautiful new dining room.”
- Victor, Resident

Our Standard Luxury 1 Bed Suite

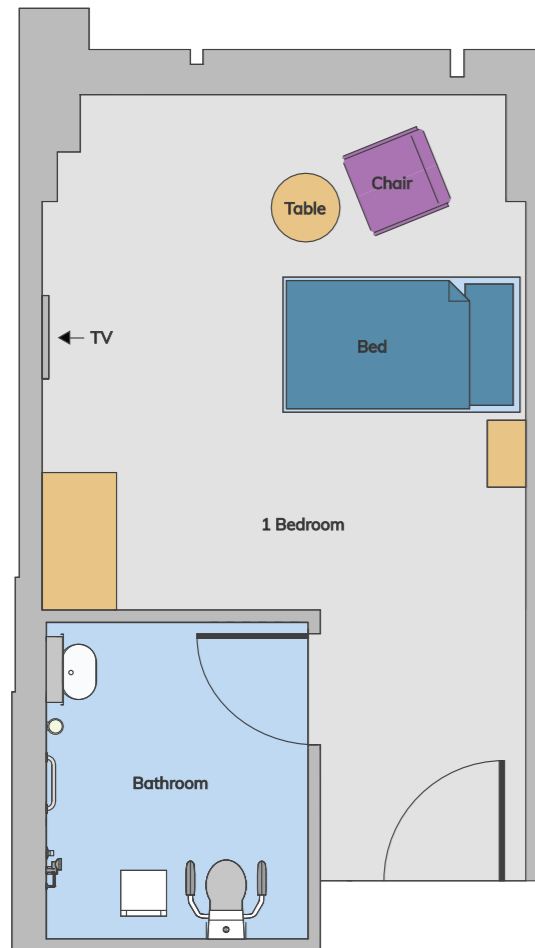

Overall generous floorspace of 27.2sqm.

Trafalgar Avenue



Our Suites

KOPWA has recently been upgraded to grow from 54 to 102 beds, with our entire facility in Roseville being redeveloped and refreshed by mid 2022. Each room is beautifully appointed with an ensuite bathroom, new flooring and modern touches. Residents will feel at home with their own television, high speed internet access as well as a generously-sized single bed

that is designed to minimise falls. Rooms come fully furnished and have built in wardrobes as well as drawers for storing personal items. Bathrooms with easy access showers offer complete privacy as well as steady grips and call-buttons. These luxury rooms were designed with comfort and convenience in mind.

“We spend sunny afternoons out in the big gardens. I enjoy the birds and the trees.”
- Ray, Resident



**Peace of mind
knowing we are
prepared for
the future.**

Book a tour with KOPWA today.

Visit www.kopwa.org.au

(02) 9412 0284

12-16 Trafalgar Ave, Roseville,

New South Wales, 2069



kopwa